

| | |
|---------------------|---|
| Part No. | IX2212 |
| Product Name | Dual-Band Wi-Fi antenna 6cm rotatable |
| Feature | Wi-Fi 2.4 and 5 GHz RP-SMA Male Connector Max Peak Gain compliant CE Certified RoHS & Reach compliant |

Electrical

| | |
|---------------------------------|------------------|
| Band | Wi-Fi 2.4 GHz |
| Frequency (MHz) | 2400~2500 |
| Efficiency Straight* | 76.7% |
| Efficiency 90° Bent* | 75.9% |
| Average Gain(dBi)* | -1.2 |
| Peak Gain Straight(dBi)* | 2.8 |
| Peak Gain 90° Bent(dBi)* | 2.7 |
| Impedance | 50 Ω |
| Polarization | Linear |
| Radiation Pattern | Omni-directional |
| Max Power Input | 10 W |

*in free space

| | |
|------------------------------------|------------------|
| Band | Wi-Fi 5 GHz |
| Frequency (MHz) | 5150~5850 |
| Efficiency Straight* | 87.5% |
| Efficiency 90° Bent* | 82.1% |
| Average Gain Straight(dBi)* | -0.6 |
| Average Gain 90° Bent(dBi)* | -0.9 |
| Peak Gain Straight(dBi)* | 3.6 |
| Peak Gain 90° Bent(dBi)* | 2.8 |
| Impedance | 50 Ω |
| Polarization | Linear |
| Radiation Pattern | Omni-directional |
| Max Power Input | 10 W |

*in free space

Environmental

| | |
|------------------------------|---------------|
| Operating Temperature | -40°C to 85°C |
|------------------------------|---------------|

| | |
|----------------------------|---------------|
| Storage Temperature | -40°C to 85°C |
|----------------------------|---------------|

Mechanical drawing (unit:mm)

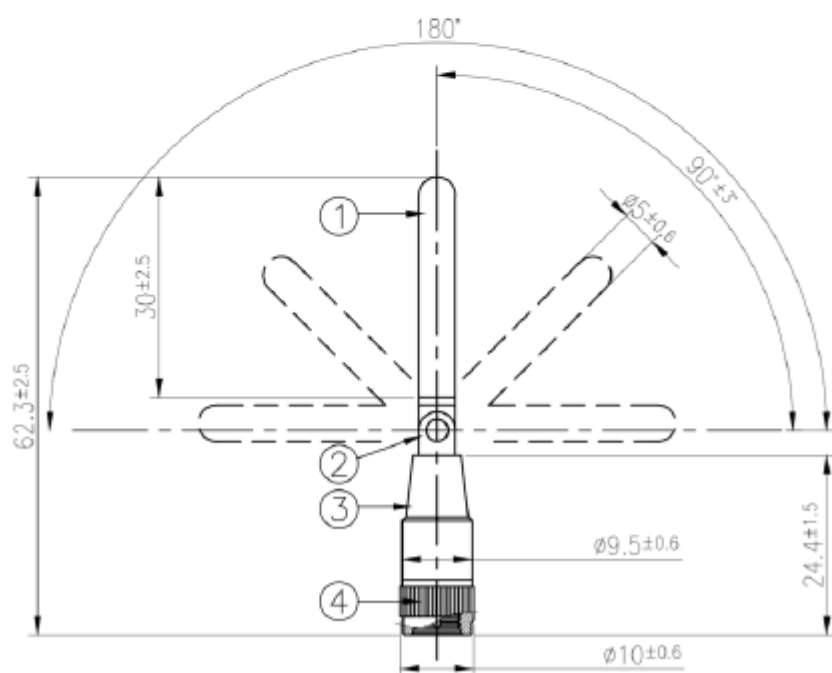
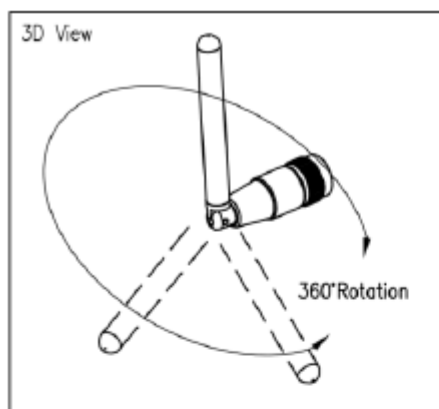

IXON makes no warranties based on the accuracy or completeness of the contents of this document and reserves the right to make changes to specifications and product descriptions at any time without notice. IXON reserves all rights to this document and the information contained herein. Reproduction, use or disclosure to third parties without express permission is strictly prohibited. Copyright © IXON B.V.